

## CRUX-0040

### ARCH BOXES

No.	Part No.	Description	Full Kit
1	SMW-0159	Arch Box Front	1
2	SMW-0160	Arch Front End	2
3	SMW-0161	Arch Box Lid Back	1
4	SMW-0162	Arch Box Lid Top	1
5	M6 16mm Slotted Set Screw	M6 16mm Slotted Set Screw	2
6	Nylon Washer	18mm x 10.5mm x 1.6mm	2
7	Foam Adhesive Tape	960mm x 15mm x 1mm	1
8	Self Adhesive Velcro	50mm x 20mm	2
9	<a href="#">Angle E2280</a>	<a href="#">316mm Long</a>	2
10	Flanged Pozi Head Screw	No.8 x 1/2" - Black	3
11	CSK Rivet	4 x 8mm	8
12	Pan Head Screw	No.8 x 1/2" - Stainless	10
13	CSK Screw	No.8 x 1/2"	2

### What's in the box?

The various kit options and their parts are noted in the table with a diagram on the following page.

*Optional Extra*

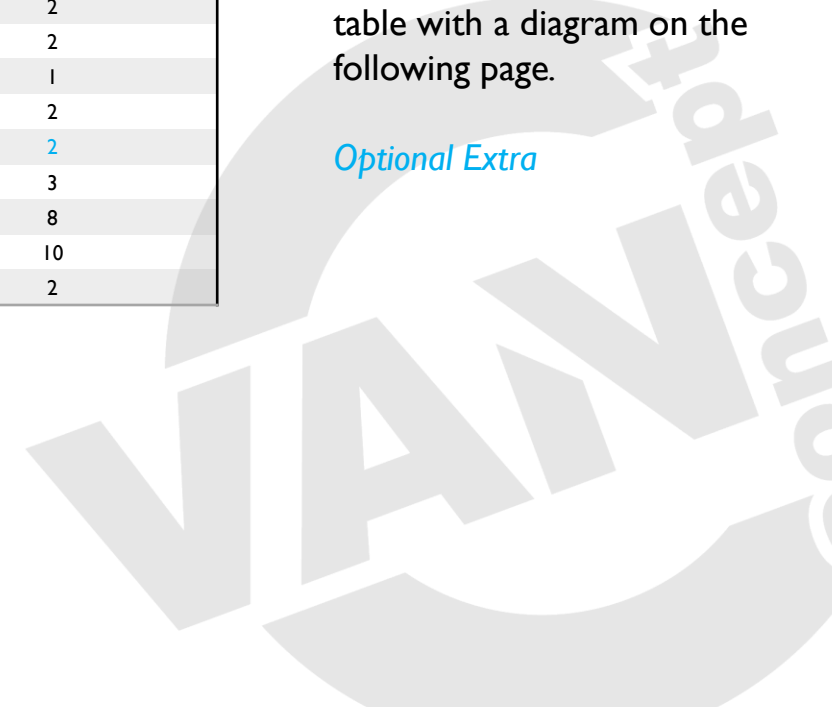

INSTRUCTIONS  
ARCH BOXES

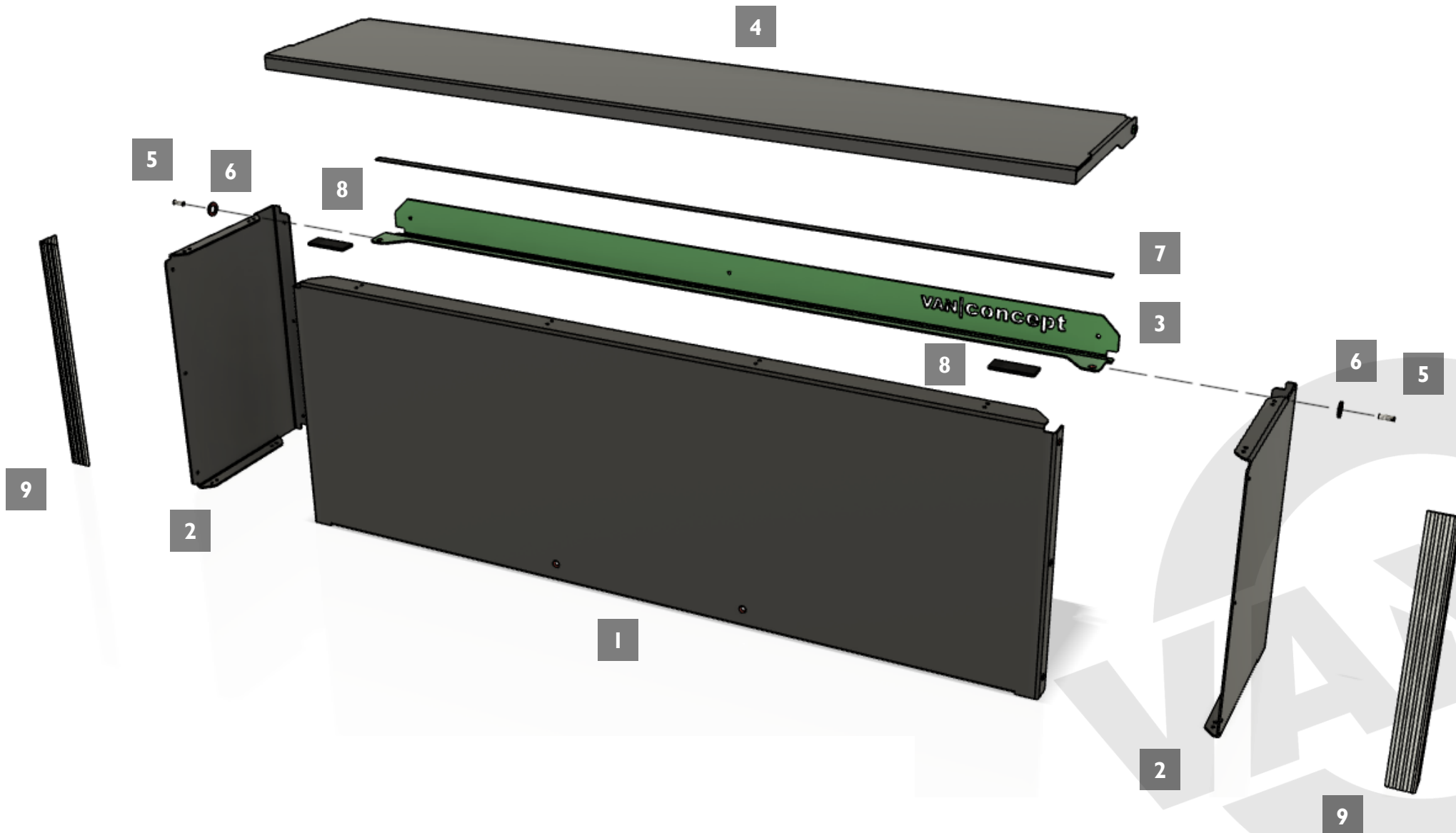

## INSTRUCTIONS ARCH BOXES



- *Prep the wheel arch with any sound deadening material prior to fitting our Arch Box.*
- A batten of wood needs to be bonded (or screwed) to the bottom corner of the wheel arch profile, as shown above. The Arch Box will screw into this, so the batten (or strips of wood) need to be the correct depth to match the Arch Box (see next page for layout).

## INSTRUCTIONS ARCH BOXES



- Offer the parts into place (including SMW-0159 – Arch Box Front) to determine the correct thickness of the batten.
- With the ends vertical and the Arch Box laid out centrally to the wheel arch, fix the two end pieces to the ply lining of the van using the pan head screws.

## INSTRUCTIONS ARCH BOXES

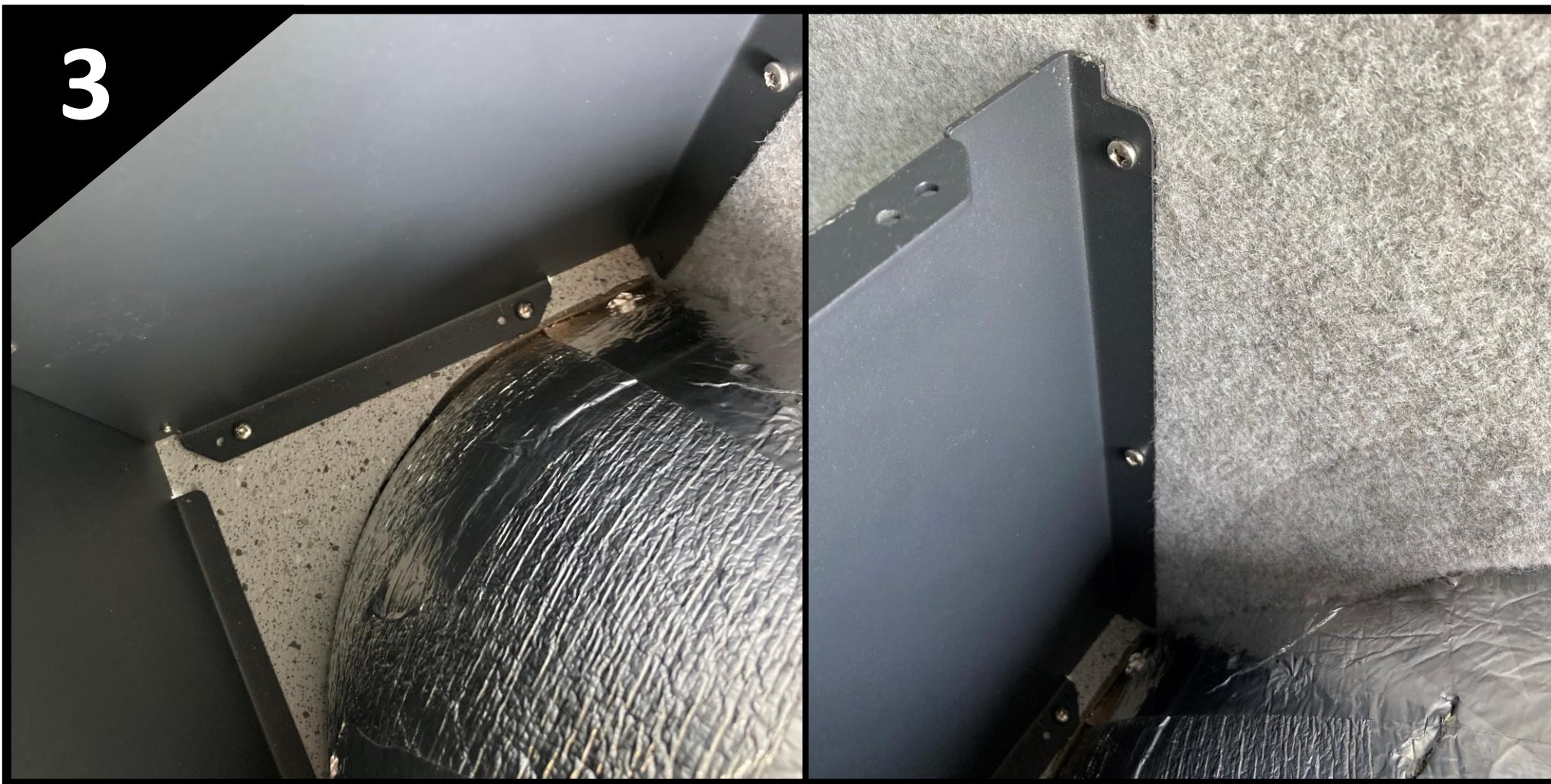

- Ensuring the Arch Box is square and the front panel fits, screw the end panels to the van floor using some more pan head screws.



- Use the countersink rivets to attach the front panel to end panels with the three holes either end.
  - Fit the remaining two countersink rivets through the lid back pieces and into the end panels.
  - Secure the lid back to the ply lining of the wall using the three flanged pozi-head screws.
- Offer the lid top into place and fit to the end panels using the M6 slotted screws and nylon washers, as shown in the exploded diagram at the start.

## INSTRUCTIONS ARCH BOXES

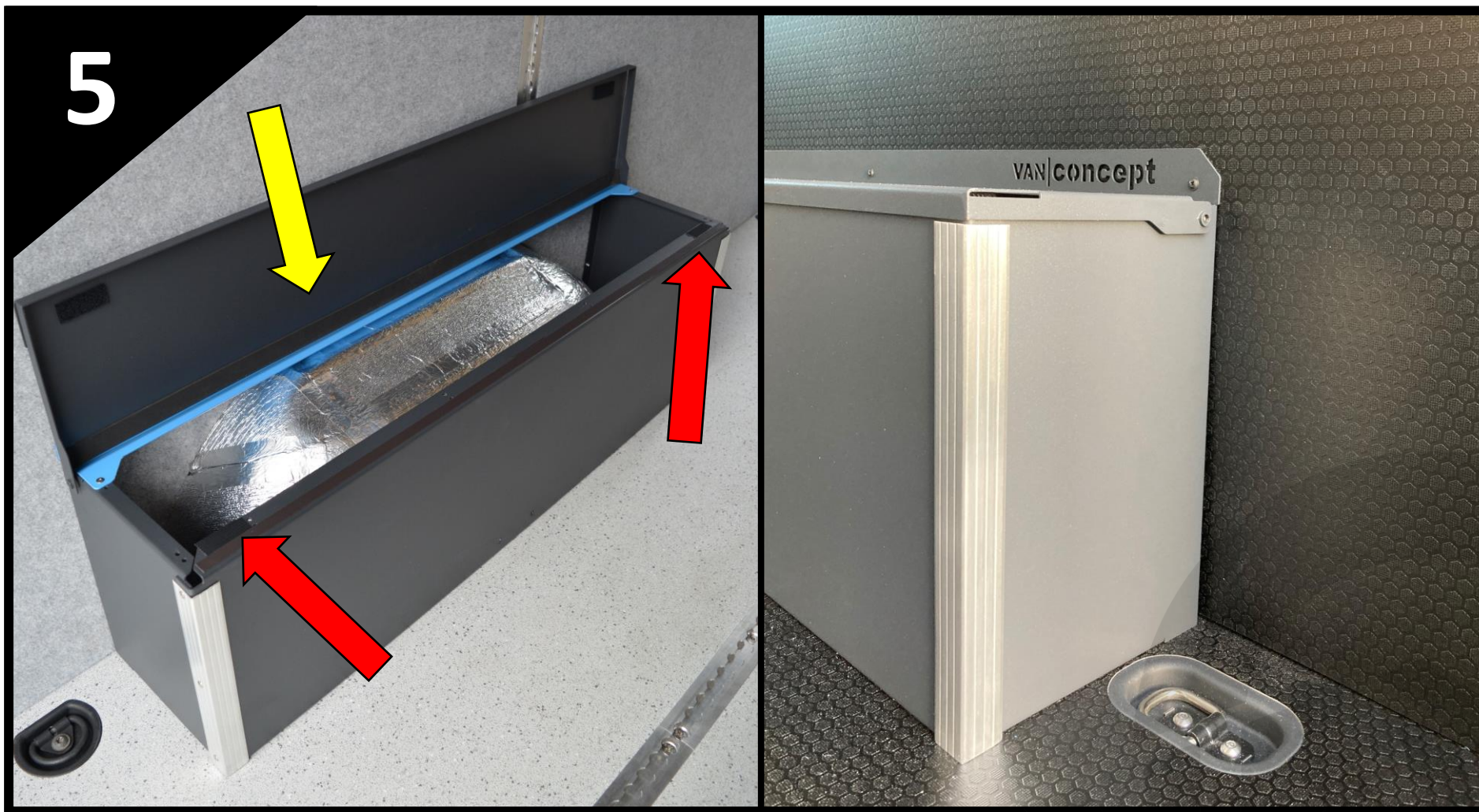

- The lid should now open, with the slotted screws acting as the hinge.
- Apply the strip of self-adhesive foam tape along the underside of the lid to sit on the lid back when closed, as shown with the yellow arrow.
  - Fit the two pieces of Velcro in the corners of the lid and top edge of the front panel, as shown with the red arrows.
    - *If fitting the optional protective corners, these can be simply bonded in place using a suitable adhesive, such as CTI.*